

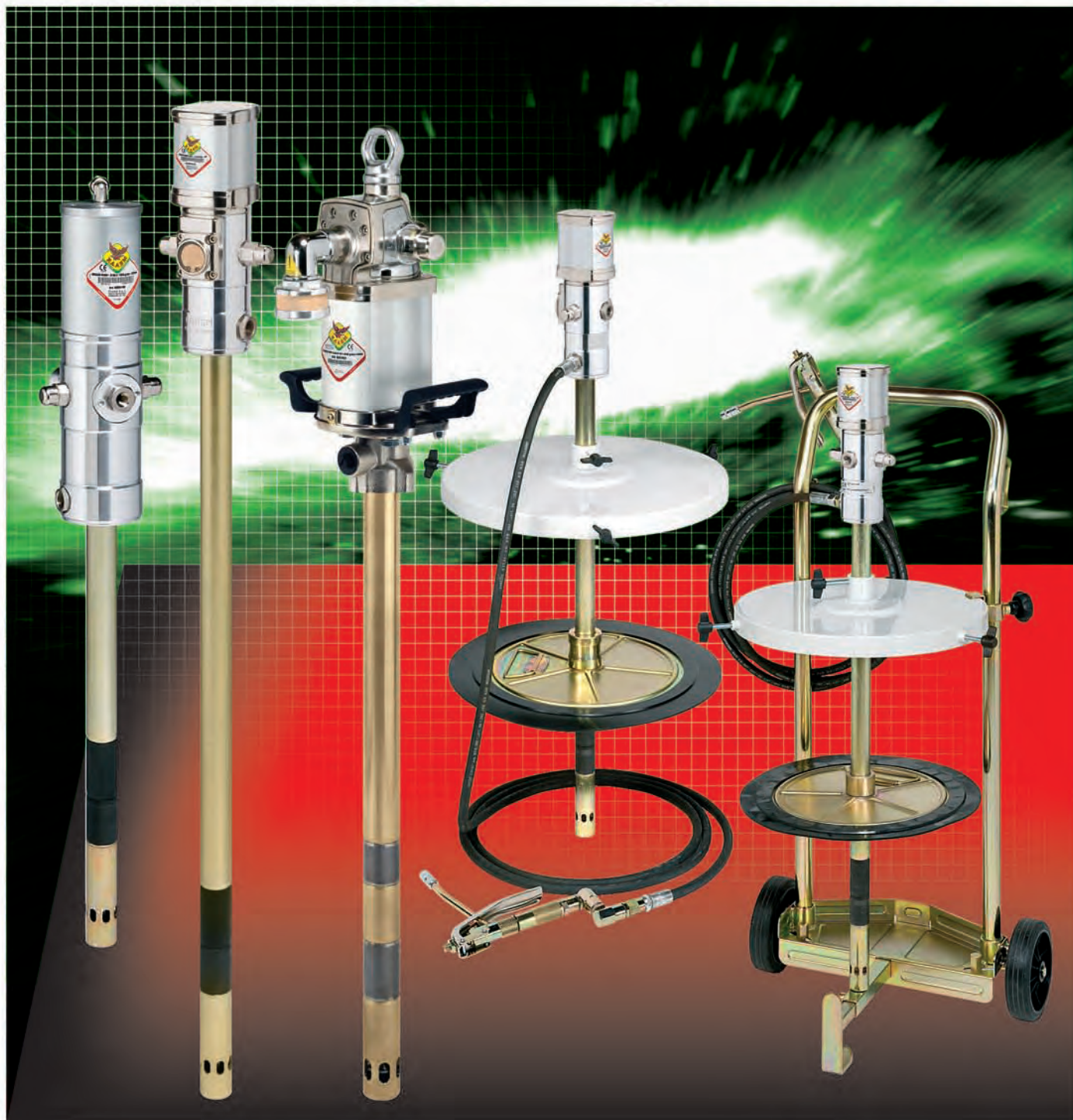







Grease pumps



 	50:1 Pumps - Series 238 and kits	page 70
	65:1 Pumps - Series 234	page 77
	Industrial grease pumps	page 78
	Accessories	page 80
	Pump elevator and Ram	page 88
	Manual grease pump	page 92



Series 238
air-operated pumps
for short/long
distance grease
distribution, for high
pressure greasing.
Ideal for dispensing
medium/high-viscosity
grease. Suitable for
mobile installations
and centralized fixed
systems.

Polyurethane seals



P/N 62141-55

P/N 62148-55

P/N 62174-55

P/N 62195-55

Compatible fluids	greases
Type of seals	polyurethane
Suction tube upper body	aluminum
Suction tube	carbon steel
Air inlet connection	1/4" NPT (f)
Grease outlet connection	1/4" NPT (f)
Air working pressure	90 - 120 psi
Air max. pressure	120 psi
Max. air consumption 120 psi	26 cfm
Noise level	81 dB
Suitable for drums	35 lb
Suction tube length	16"
Suction tube external diameter	ø 1.18"

No. 1 packing 0.35 ft³ 11 lb

Compatible fluids	greases
Type of seals	polyurethane
Suction tube upper body	aluminum
Suction tube	carbon steel
Air inlet connection	1/4" NPT (f)
Grease outlet connection	1/4" NPT (f)
Air working pressure	90 - 120 psi
Air max. pressure	120 psi
Max. air consumption 120 psi	26 cfm
Noise level	81 dB
Suitable for drums	35 lb
Suction tube length	19"
Suction tube external diameter	ø 1.18"

No. 1 packing 0.35 ft³ 11 lb

Compatible fluids	greases
Type of seals	polyurethane
Suction tube upper body	aluminum
Suction tube	carbon steel
Air inlet connection	1/4" NPT (f)
Grease outlet connection	1/4" NPT (f)
Air working pressure	90 - 120 psi
Air max. pressure	120 psi
Max. air consumption 120 psi	26 cfm
Noise level	81 dB
Suitable for drums	120 lb
Suction tube length	29"
Suction tube external diameter	ø 1.18"

No. 1 packing 0.70 ft³ 14 lb

Compatible fluids	greases
Type of seals	polyurethane
Suction tube upper body	aluminum
Suction tube	carbon steel
Air inlet connection	1/4" NPT (f)
Grease outlet connection	1/4" NPT (f)
Air working pressure	90 - 120 psi
Air max. pressure	120 psi
Max. air consumption 120 psi	26 cfm
Noise level	81 dB
Suitable for drums	400 lb
Suction tube length	37"
Suction tube external diameter	ø 1.18"

No. 1 packing 0.70 ft³ 16 lb

USES

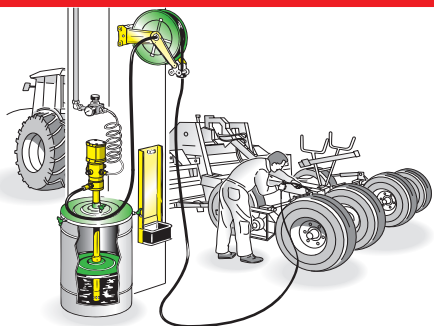

The pump suction tube is made with a combination of special, heat treated steel, without the use of seals in order to eliminate any problem of wear.

PUMP PERFORMANCE

A 116 psi
B 87 psi
C 58 psi

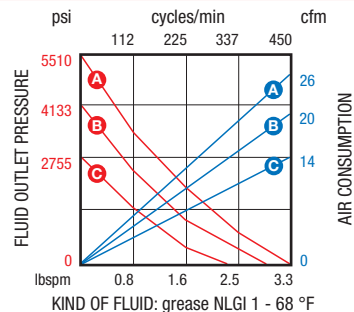

Mobile grease Kits.

The ideal combination for dispensing grease in any workplace. The very easy to handle dolly is equipped with a drum (400 lb) clamping device, adjustable side support for hooking accessories, and wheel with brake.

The mobile kit comes with a handy hose reel with 40' of hose.

By request the mobile unit can be equipped with other hose reels, (see page 103).



P/N 64001-55

Mobile grease dispenser unit with hose reel, for drums of 400 lb

Pump 50:1	62195-55
Heavy duty dolly	80210-55
Hose reel 1/4" - 40'	8430.501-55
Handle with triple swivel joint	66882-55
Hose 1/4" - 5'	995.702-55
Drum cover Ø 24"	65600-55
Follower plate Ø 23"	66590-55

 No.1 packing 10.6 ft³  177 lb

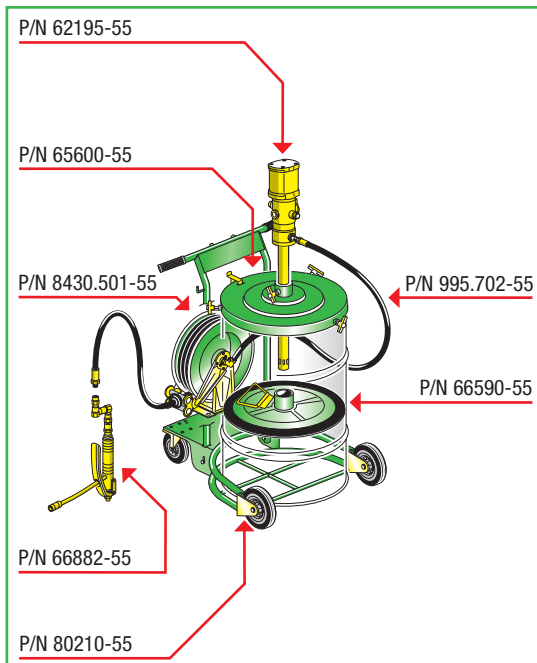

USES

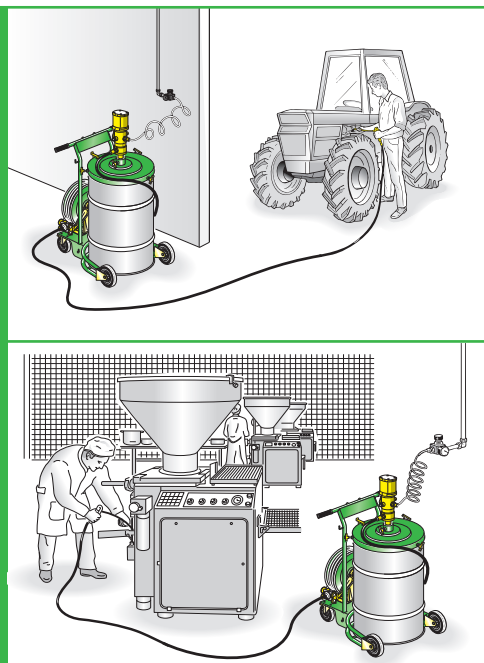

Dolly-mounted grease kit.

The ideal combination for dispensing grease in any workplace.

The compact dolly (P/N 80040-55) has 2 fixed wheels that make it very easy to handle. It is equipped with a pump support and is suitable for small-medium-size containers.



Ø 13"-15"

P/N 64039-55

Dolly-mounted grease dispenser kit, for drums 120 lb, with external Ø 13" - 15"

Pump 50:1	62174-55
Dolly	80040-55
Handle with triple swivel joint	66882-55
Hose 1/4" - 13'	993.504-55
Drum cover	65385-55 (Ø 15.2")
Follower plate	66370-55 (Ø 14.6")

No.1 packing 1.7 ft³ 46 lb

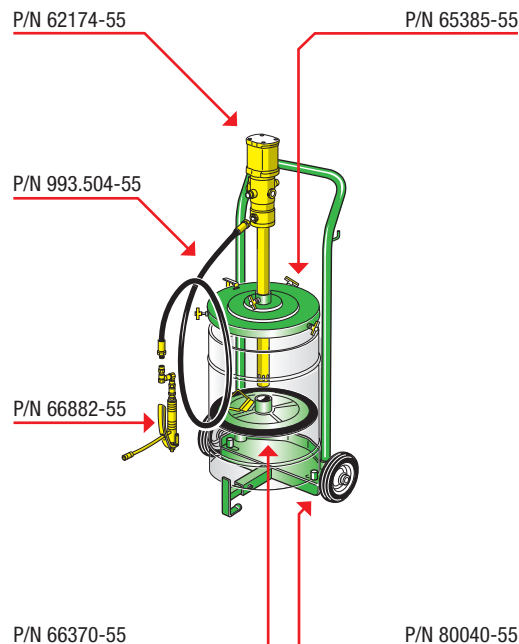

USES

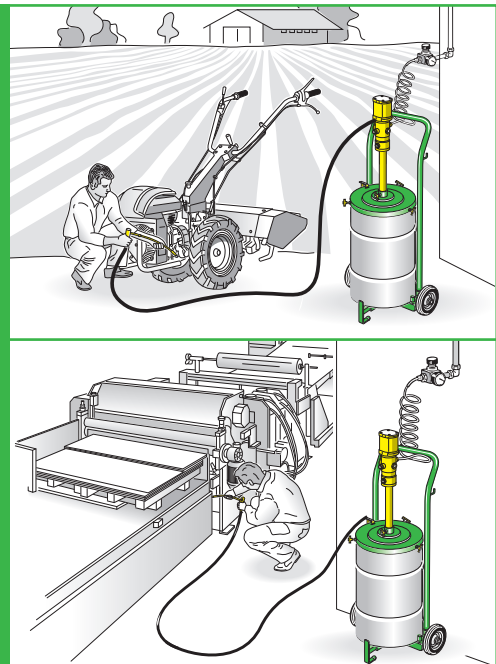

Dolly-mounted and portable grease kit.

The ideal combination for dispensing grease in any workplace. The entirely galvanized dollies are also suitable for carrying 35 lb containers. Their compact size makes them very easy to handle and their modularity enables compact packing for easy transport and storage.



Ø 10"-12"



P/N 64033/40-55

Dolly-mounted grease dispenser kit, for drums
35 lb, with external Ø 10"-12"

Pump 50:1	62148-55
Dolly	80040-55
Handle with triple swivel joint	66882-55
Hose 1/4" - 13'	993.504-55
Kit carrying handle	-
Drum cover	65310-55 (Ø 12.2")
Follower plate	66310-55 (Ø 12.2")

No.1 packing 1.4 ft³ 40 lb



Ø 10"-12"



P/N 64031-55

Portable grease dispenser kit, for drums
35 lb, with external Ø 10"-12"

62148-55
-
66882-55
993.504-55
66599-55
65310-55 (Ø 12.2")
66310-55 (Ø 12.2")

No.1 packing 0.9 ft³ 25 lb

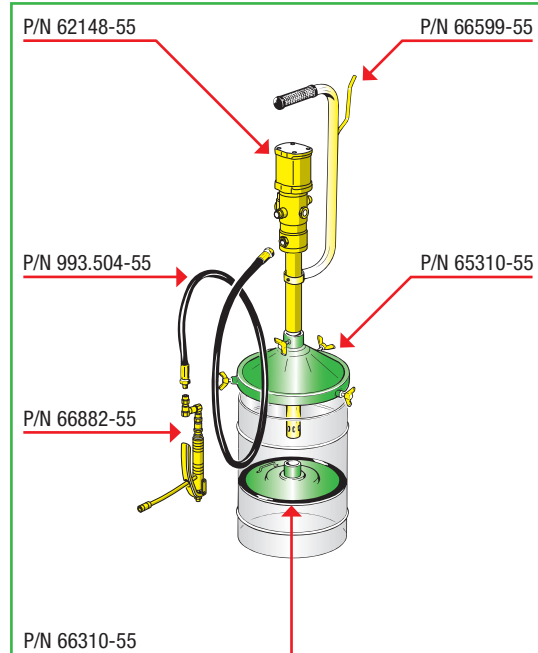
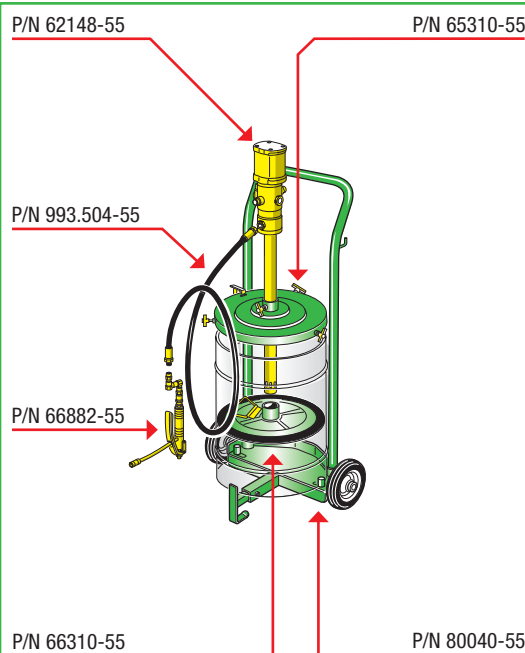

**Portable grease kit.**

The ideal combination for dispensing grease in any workplace. Compact in size, they enable easy changing of the container (drum or bucket) and quick greasing of any motor vehicle or mechanism. They are equipped with a grease follower plate and cover that protects the lubricant while preserving its characteristics.



Ø 12"-14"



P/N 64036-55

Dolly-mounted grease dispenser kit, for special size drums 35 lb, with external Ø 12"-14"



Ø 9"-11"



P/N 64021-55

Portable grease dispenser kit, for special size drums 35 lb, with external Ø 9"-11"

Pump 50:1	62148-55
Dolly	80040-55
Handle with triple swivel joint	66882-55
Hose 1/4" - 13'	993.504-55
Kit carrying handle	-
Drum cover	65350-55 (Ø 13.8")
Follower plate	66340-55 (Ø 13.4")

No.1 packing 0.9 ft³ 25 lb

62141-55
-
66882-55
993.504-55
66599-55
65280-55 (Ø 11.0")
66265-55 (Ø 10.4")

No.1 packing 1.0 ft³ 26 lb

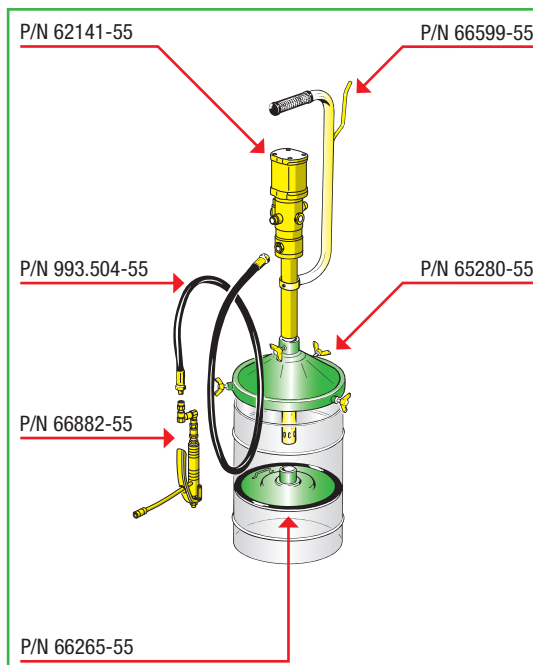
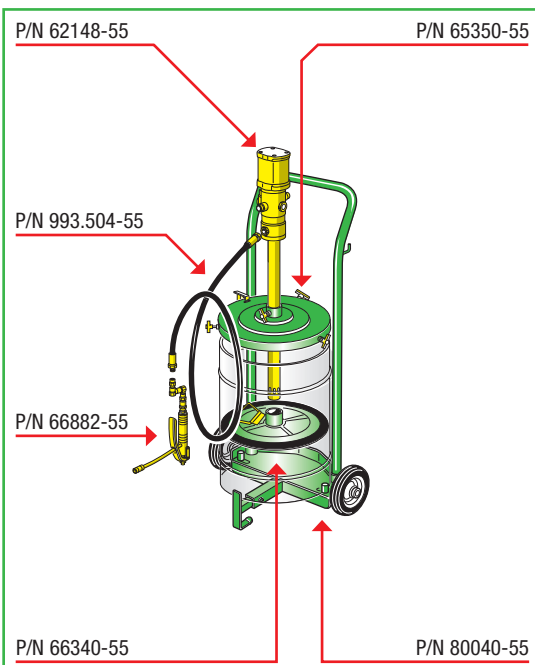

Grease dispensing systems for use with drum.

A complete solution for delivering grease from an independent fixed station and with connection to a centralized system for dispensing from storage zones.



P/N 64143-55

Grease dispenser kit with pump for drums 120 lb, with external \varnothing 13"-15"

P/N 64144-55

Grease dispenser kit with pump, with external \varnothing 15"-17"



P/N 64194-55

Grease dispenser kit with pump for drums 400 lb, with external \varnothing 22" - 24"

Pump 50:1	62174-55
Handle with triple swivel joint	66882-55
Hose 1/4" - 13'	993.504-55
Drum cover	65385-55 (\varnothing 15.2")
Follower plate	66370-55 (\varnothing 14.6")

62174-55
66882-55
993.504-55
65420-55 (\varnothing 16.5")
66400-55 (\varnothing 15.8")

62195-55
66882-55
993.504-55
65600-55 (\varnothing 23.6")
66590-55 (\varnothing 23.0")

No.1 packing 2.1 ft³ 37 lb

No.1 packing 3.2 ft³ 51 lb

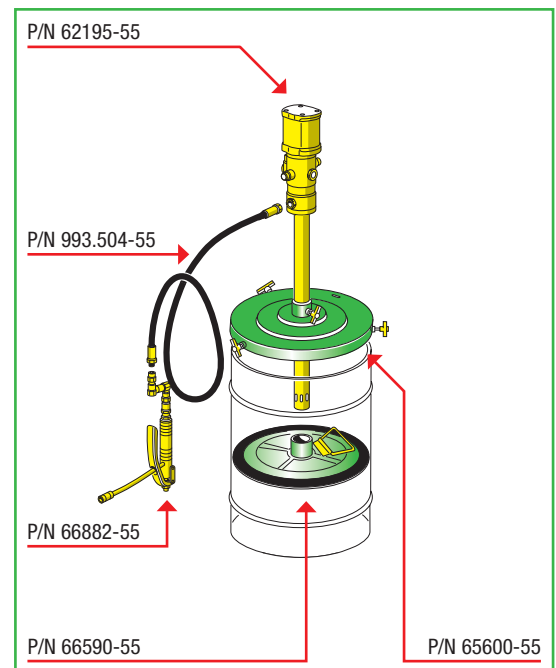
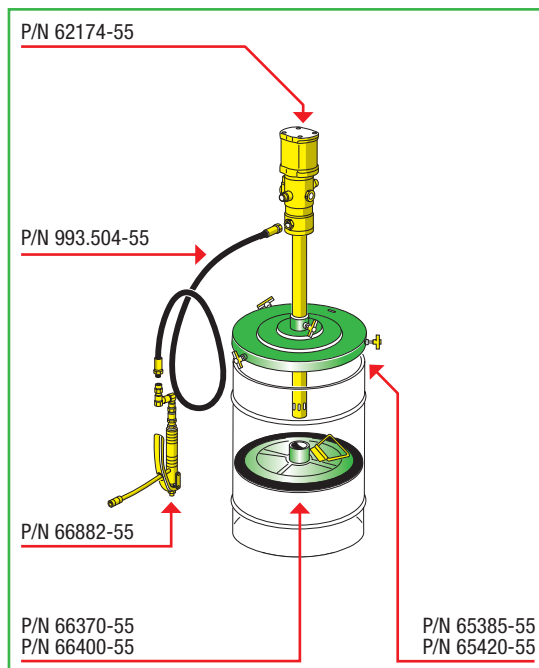



Grease dispensing systems with pump applied on drum, equipped with series 430 swivelling hose reel.

A complete solution for delivering grease from an independent fixed station and with connection to a centralized system for dispensing from storage zones.



P/N 64157-55

Wall-mounted grease dispenser kit with pump for drums 120 lb, with external \varnothing 13" - 15"



P/N 64202-55

Wall-mounted grease dispenser kit with pump for drums 400 lb, with external \varnothing 22" - 24"

Pump 50:1	62174-55
Hose reel 1/4" - 40'	8430.501-55
Handle with triple swivel joint	66882-55
Hose 1/4" - 5'	995.702-55
Drum cover	65385-55 (\varnothing 16.5")
Follower plate	66370-55 (\varnothing 16.5")

No.1 packing 4.6 ft³ 83 lb

62195-55
8430.501-55
66882-55
995.702-55
65600-55 (\varnothing 23.6")
66590-55 (\varnothing 23.0")

No.1 packing 5.3 ft³ 147 lb

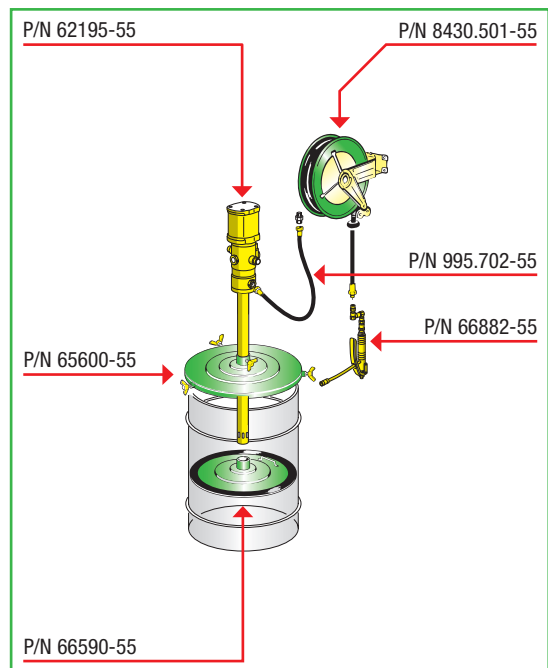
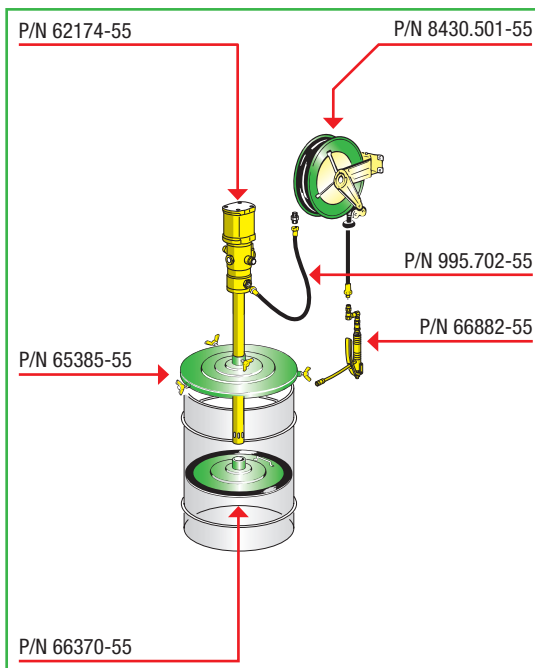

Series 234
air-operated pumps
for short/long
distance grease
distribution, for high
pressure greasing.
Ideal for dispensing
medium/high-
viscosity grease.
Suitable for long
distance dispensing.
Recommended when
delivery of a greater
quantity of grease
with high pressure is
required.

Polyurethane seals



P/N 63041-55

P/N 63048-55

P/N 63074-55

P/N 63095-55

Compatible fluids	greases
Type of seals	polyurethane
Suction tube upper body	aluminum
Suction tube	carbon steel
Air inlet connection	1/4" NPT (f)
Grease outlet connection	1/4" NPT (f)
Air working pressure	90 - 120 psi
Air max. pressure	120 psi
Max. air consumption 120 psi	42 cfm
Noise level	81 dB
Suitable for drums	35 lb
Suction tube length	16"
Suction tube external diameter	ø 1.18"

No.1 packing 0.35 ft³ 13 lb

Compatible fluids	greases
Type of seals	polyurethane
Suction tube upper body	aluminum
Suction tube	carbon steel
Air inlet connection	1/4" NPT (f)
Grease outlet connection	1/4" NPT (f)
Air working pressure	90 - 120 psi
Air max. pressure	120 psi
Max. air consumption 120 psi	42 cfm
Noise level	81 dB
Suitable for drums	35 lb
Suction tube length	19"
Suction tube external diameter	ø 1.18"

No.1 packing 0.35 ft³ 13 lb

Compatible fluids	greases
Type of seals	polyurethane
Suction tube upper body	aluminum
Suction tube	carbon steel
Air inlet connection	1/4" NPT (f)
Grease outlet connection	1/4" NPT (f)
Air working pressure	90 - 120 psi
Air max. pressure	120 psi
Max. air consumption 120 psi	42 cfm
Noise level	81 dB
Suitable for drums	120 lb
Suction tube length	29"
Suction tube external diameter	ø 1.18"

No.1 packing 0.70 ft³ 16 lb

Compatible fluids	greases
Type of seals	polyurethane
Suction tube upper body	aluminum
Suction tube	carbon steel
Air inlet connection	1/4" NPT (f)
Grease outlet connection	1/4" NPT (f)
Air working pressure	90 - 120 psi
Air max. pressure	120 psi
Max. air consumption 120 psi	42 cfm
Noise level	81 dB
Suitable for drums	400 lb
Suction tube length	37"
Suction tube external diameter	ø 1.18"

No.1 packing 0.70 ft³ 18 lb

USES

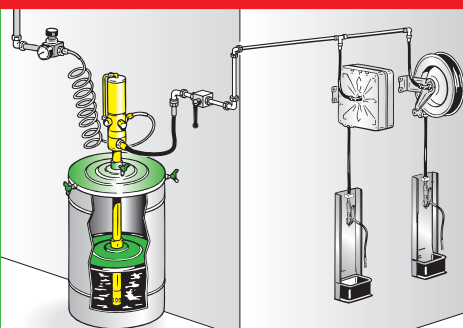

The pumps are equipped with a filter at the air inlet and a filter at the bottom of the suction tube grease inlet passage. They have a double valve enabling delivery of the grease in a continuous and constant flow. These devices prevent obstructions and consequent interruptions due to the passage of impurities.

PUMP PERFORMANCE

A 116 psi
B 87 psi
C 58 psi

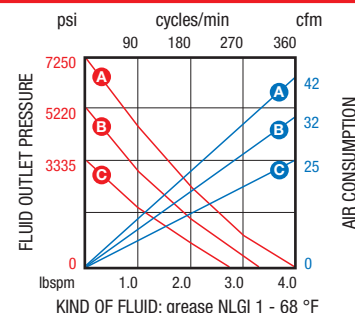

Technology, efficiency and reliability

RAASM manufactures a wide range of pumps that are among the leaders in the market. Innovative design combined with high quality materials guarantee high returns of capacity and pressure.

* with NLGI 2 - 70 °F free outlet

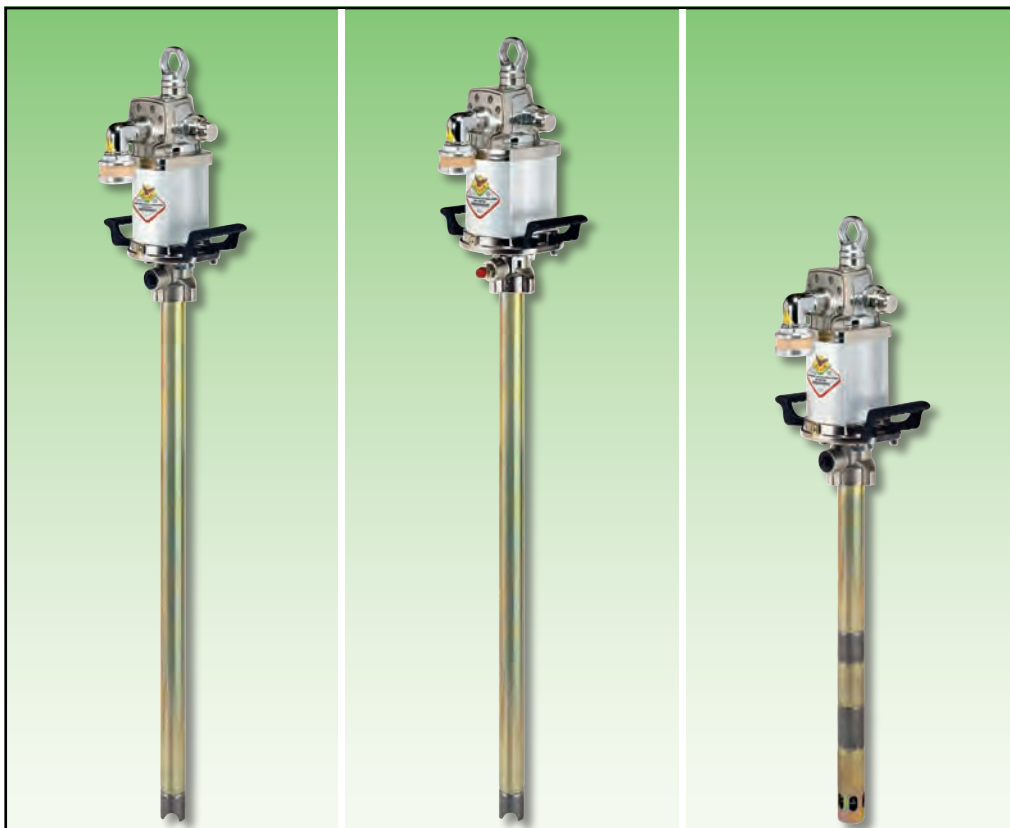

Series	312	412	312
Compression ratio	11:1	18:1	45:1
Capacity *	50 lb/min	37 lb/min	9.7 lb/min
Suitable for drums 120 lb	-	-	92F/451-55
Suitable for drums 400 lb	91F/111-55	116F/181-55	91F/451-55
Pump elevator	-	-	90FSP/451-55
Tank	-	-	90F/451-55
Compatible fluids	oils, lubricants and grease	oils, lubricants and grease	high viscosity oils and greases
Type of seals	polyurethane	polyurethane	polyurethane
Suction tube upper body	carbon steel	carbon steel	carbon steel
Suction tube	carbon steel	carbon steel	carbon steel
Air inlet connection	1/2" NPT (f)	1/2" NPT (f)	1/2" NPT (f)
Fluid outlet connection	3/4" NPT (f)	3/4" NPT (f)	1/2" NPT (f)
Air working pressure	90 - 120 psi	90 - 120 psi	90 - 120 psi
Air max. pressure	120 psi	120 psi	120 psi
Noise level	80 dB	80 dB	80 dB
Deliverable oil temperature	14 - 140 °F	14 - 140 °F	14 - 140 °F
Max. air consumption 120 psi	60 cfm	99 cfm	60 cfm
Suction tube external diameter	1.8"	1.8"	1.8"

Suitable for
drums 120 lb

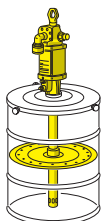

Suitable for
drums 400 lb

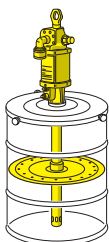

Pump
elevator

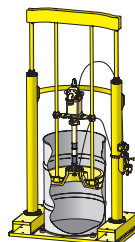

Tank

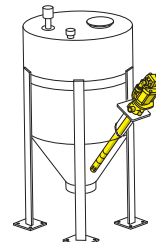



312 70:1 6.6 lb/min	412 75:1 9.7 lb/min	412 40:1 22 lb/min	600 70:1 15.4 lb/min
92C/701-55	117F/751-55	115F/401-55	150F/701-55
91C/701-55	116F/751-55	116F/401-55	151F/701-55
-	115FSP/751-55	118FSP/401-55	153FSP/701-55
-	115F/751-55	117F/401-55 - 118F/401-55	152F/701-55 - 153F/701-55

high viscosity oils and greases	high viscosity oils and greases	high viscosity oils and greases	high viscosity oils and greases
polyurethane	polyurethane	polyurethane	polyurethane
carbon steel	carbon steel	carbon steel	carbon steel
carbon steel	carbon steel	carbon steel	carbon steel
1/2" NPT (f)	1/2" NPT (f)	1/2" NPT (f)	1/2" NPT (f)
1/2" NPT (f)	1/2" NPT (f)	1/2" NPT (f)	1/2" NPT (f)
90 - 120 psi	90 - 120 psi	90 - 120 psi	90 - 120 psi
120 psi	120 psi	120 psi	120 psi
80 dB	80 dB	80 dB	80 dB
14 - 140 °F	14 - 140 °F	14 - 140 °F	14 - 140 °F
60 cfm	99 cfm	99 cfm	56,50 cfm
1.8"	1.8"	2"	2"

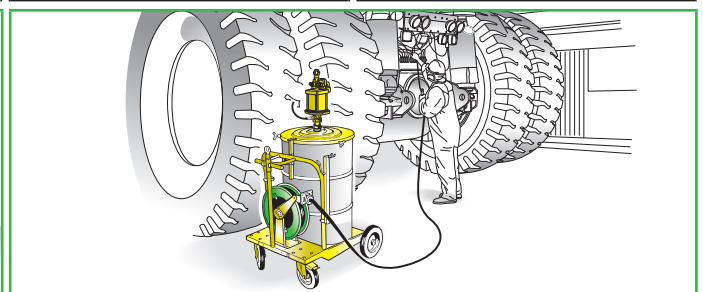
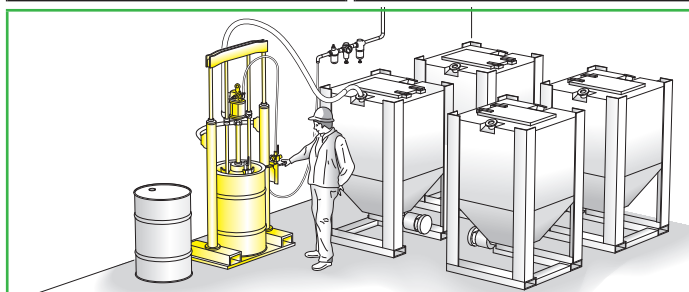



FOLLOWER PLATE FOR PUMPS SERIES 238 - 234 WITH SUCTION TUBE \varnothing 1.18"

P/N 66265-55

Follower plate \varnothing 10.4" for 35 lbs container (internal \varnothing 9.5"-10.2")

P/N 66310-55

Follower plate \varnothing 12.2" for 35-60 lbs container (internal \varnothing 10.0"-11.8")

P/N 66340-55

Follower plate \varnothing 13.4" for 35-60 lbs container (internal \varnothing 11.8"-13.0")

P/N 66370-55

Follower plate \varnothing 14.6" for 120 lbs container (internal \varnothing 13.2"-14.2")

P/N 66400-55

Follower plate \varnothing 15.8" for 120 lbs container (internal \varnothing 14.2"-15.8")

P/N 66590-55

Follower plate \varnothing 23.0" for 400 lbs container (internal \varnothing 21.3"-22.9")

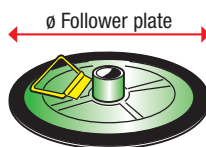

Union \varnothing 1.18"

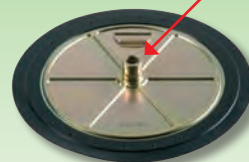

FOLLOWER PLATE FOR PUMPS SERIES 312 - 412 WITH SUCTION TUBE \varnothing 1.77"

P/N 10/60-55

Follower plate \varnothing 23.0" for 400 lbs container (internal \varnothing 21.3"-22.9")

P/N 10/61-55

Follower plate \varnothing 15.8" for 120 lbs container (internal \varnothing 14.2"-15.8")

P/N 10/62-55

Follower plate \varnothing 14.6" for 120 lbs container (internal \varnothing 13.2"-14.2")

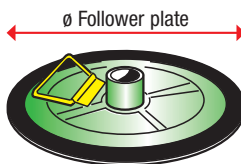

Union \varnothing 1.77"

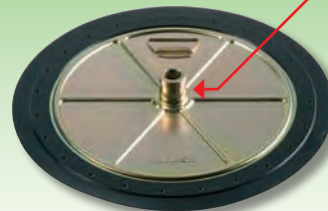

FOLLOWER PLATE FOR PUMPS SERIES 412 WITH SUCTION TUBE \varnothing 2.00"

P/N 10/65-55

Follower plate \varnothing 23.0" for 400 lbs container (internal \varnothing 21.3"-22.9")

P/N 10/66-55

Follower plate \varnothing 15.8" for 120 lbs container (internal \varnothing 14.2"-15.8")

P/N 10/67-55

Follower plate \varnothing 14.6" for 120 lbs container (internal \varnothing 13.2"-14.2")

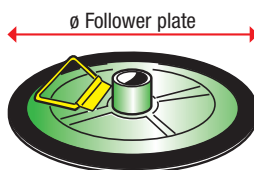

Union \varnothing 2.00"

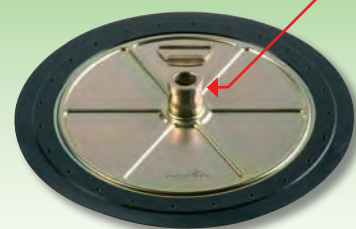

DETAILS AND ADVANTAGES

The follower plate is always recommended but becomes indispensable when using particularly hard greases. The follower plate is pulled towards the bottom of the drum by the vacuum created by the pump and always ensures the following advantages:

- it compresses the grease, preventing air pockets formation and possible cavitation of the pump,
- it keeps the grease clean, as well as preserving its characteristics,
- it enables collection of all the grease from the bottom of the drum, that would otherwise remain attached to the sides.

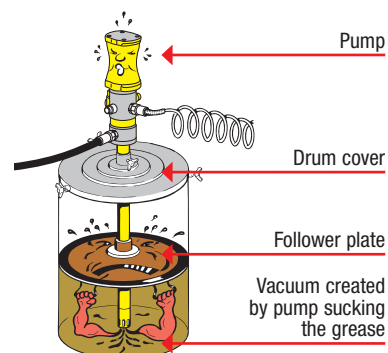
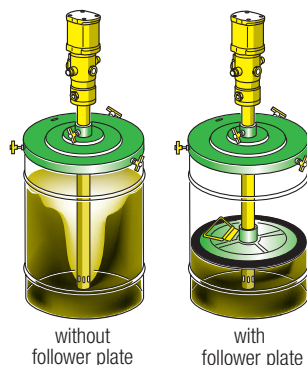

DRUM COVER FOR PUMPS SERIES 238 - 234 WITH SUCTION TUBE Ø 1.18"

P/N 65280-55

Drum cover Ø 11.0" for 35 lbs container (external Ø 9.5"-11")

P/N 65310-55

Drum cover Ø 12.2" for 35-60 lbs container (external Ø 10.2"-11.8")

P/N 65350-55

Drum cover Ø 13.8" for 35-60 lbs container (external Ø 11.8"-13.8")

P/N 65385-55

Drum cover Ø 15.2" for 120 lbs container (external Ø 13.4"-15.2")

P/N 65420-55

Drum cover Ø 16.5" for 120 lbs container (external Ø 14.6"-16.5")

P/N 65600-55

Drum cover Ø 23.6" for 400 lbs container (external Ø 21.7"-23.6")

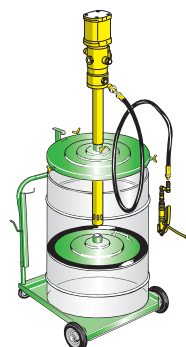

Union Ø 1.18"



DRUM COVER FOR PUMPS SERIES 312 - 412 WITH SUCTION TUBE Ø 1.77"

P/N 10/50-55

Drum cover Ø 23.6" for 400 lbs container (external Ø 21.7"-23.6")

P/N 10/51-55

Drum cover Ø 16.5" for 120 lbs container (external Ø 14.6"-16.5")

P/N 10/52-55

Drum cover Ø 15.2" for 120 lbs container (external Ø 13.4"-15.2")



Union Ø 1.77"



DRUM COVER FOR PUMPS SERIES 412 WITH SUCTION TUBE Ø 2.0"

P/N 10/55-55

Drum cover Ø 23.6" for 400 lbs container (external Ø 21.7"-23.6")

P/N 10/56-55

Drum cover Ø 16.5" for 120 lbs container (external Ø 14.6"-16.5")

P/N 10/57-55

Drum cover Ø 15.2" for 120 lbs container (external Ø 13.4"-15.2")

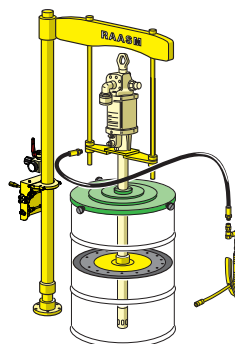

Union Ø 2"



DRUM COVER WITH THREADED BUSHING 2" F

P/N 65160-55

Drum cover Ø 23.6" for 400 lbs container (external Ø 21.7"-23.6")

P/N 65142-55

Drum cover Ø 16.5" for 120 lbs container (external Ø 14.6"-16.5")

P/N 65138-55

Drum cover Ø 15.2" for 120 lbs container (external Ø 13.4"-15.2")

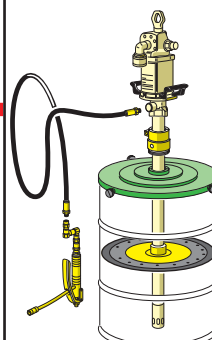

2" Female Union

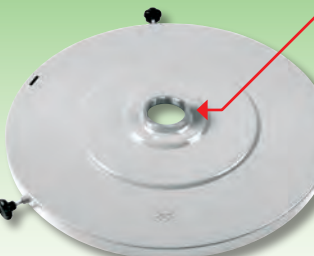

**P/N 65709-55**

Tie down kit suitable for 120 lb container.

Equipped with:

- drum cover, external ø 15.2", union 1.18"
- regulating knobs
- 2 rods with eye bolts

P/N 65711-55

Tie down kit suitable for 400 lb container.

Equipped with:

- drum cover, external ø 23.6", union 1.18"
- regulating knobs
- 2 rods with eye bolts

Union ø 1.18"

Note: the drum is not part of the kit

P/N 65715-55

Tie down kit suitable for 120 lb container.

Equipped with:

- drum cover, external ø 15.2", union 1.77"
- regulating knobs
- 2 rods with eye bolts

P/N 65717-55

Tie down kit suitable for 400 lb container.

Equipped with:

- drum cover, external ø 23.6", union 1.77"
- regulating knobs
- 2 rods with eye bolts

Union ø 1.77"

Note: the drum is not part of the kit

P/N 65721-55

Tie down kit suitable for 120 lb container.

Equipped with:

- drum cover, external ø 15.2", union 2"
- regulating knobs
- 2 rods with eye bolts

P/N 65723-55

Tie down kit suitable for 400 lb container.

Equipped with:

- drum cover, external ø 23.6", union 2"
- regulating knobs
- 2 rods with eye bolts

Union ø 2"

Note: the drum is not part of the kit

P/N 65727-55

Tie down kit suitable for 120 lb container.

Equipped with:

- drum cover, external \varnothing 15.2", female union 2"
- regulating knobs
- 2 rods with eye bolts

P/N 65729-55

Tie down kit suitable for 400 lb container.

Equipped with:

- drum cover, external \varnothing 23.6", female union 2"
- regulating knobs
- 2 rods with eye bolts

2" Female Union



Note: the drum is not part of the kit

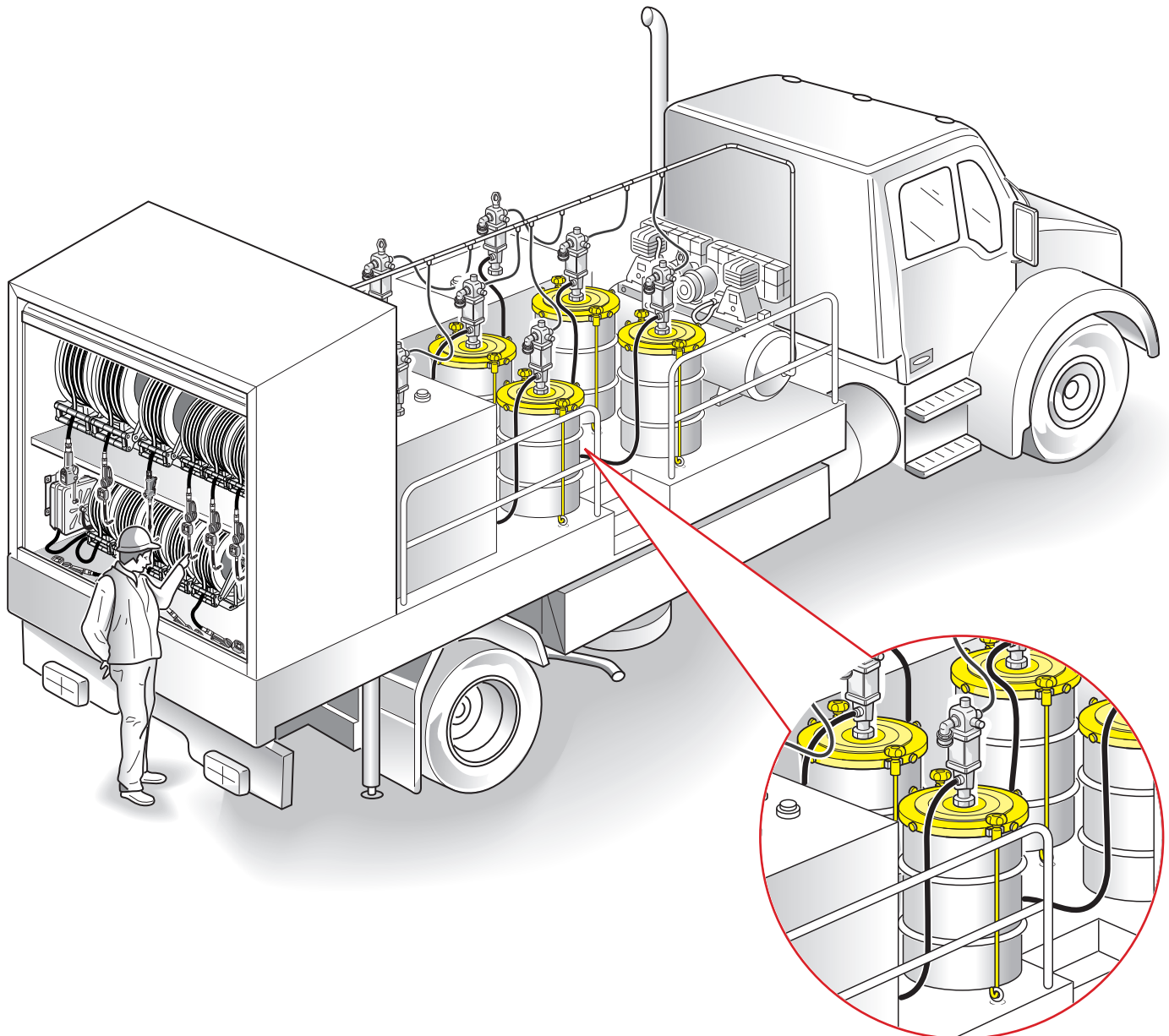

**NIPPLES**

- P/N 111414-55 Nipple 1/4" NPTF (m) x 1/4" NPTF (m)
- P/N 111438-55 Nipple 1/4" NPTF (m) x 3/8" NPTF (m)
- P/N 113838-55 Nipple 3/8" NPTF (m) x 3/8" NPTF (m)

**ADAPTORS**

- P/N 121438-55 Adaptor 1/4" NPTF (m) x 3/8" NPTF (f)
- P/N 123814-55 Adaptor 3/8" NPTF (m) x 1/4" NPTF (f)



P/N 121438-55



P/N 123814-55

P/N 60450-55

Female quick connector complete with check valve - 1/4" NPT (f)
max. pressure 5000 psi



* Articles not manufactured by RAASM

P/N 60451-55

Male quick connector complete with check valve - 1/4" NPT (f)
max. pressure 5000 psi



* Articles not manufactured by RAASM

P/N 66661-55

Straight single swivel joint 1/4" NPT (m) x 1/4" NPT (f)
suitable for grease handle P/N 66855-55

P/N 66665-55

Straight single swivel joint 3/8" NPT (m) x 3/8" NPT (f)
suitable for grease handle P/N 66870-55

**P/N 66663-55**

Triple swivel joint - 1/4" NPT (m) x 1/4" NPT (f)
supplied with grease handle P/N 66882-55 - 66889-55

P/N 66667-55

Triple swivel joint - 3/8" NPT (m) x 3/8" NPT (f)
supplied with grease handle P/N 66873-55 - 66876-55



P/N 66740-55

Special 4-jaw grease coupler with antisplash valve fitted standard on all grease handles



P/N 66741-55

90° grease coupler



P/N 66742-55

Hooking grease coupler



P/N 66743-55

Push-on grease coupler



P/N 10/09-55

Adaptor for integral and flanged pumps series 312 - 412, for application with other brackets

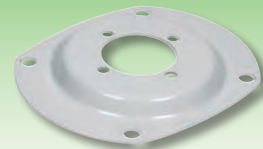
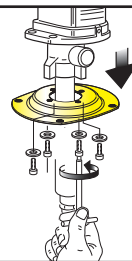

P/N 66599-55

Handle for portable grease kit supplied with grease kits P/N 64021-55 - P/N 64031-55



**P/N 37801-55**

Pressure regulator with pressure gauge - connections 1/4" NPT (m/f) applied on a pump or on the tank of a suction/drain, for regulating the compressed air inlet pressure

P/N 37818-55

Pressure regulator with pressure gauge - connections 3/8" NPT (m/f) applied on a pump for regulating the compressed air inlet pressure

P/N 37814-55

Pressure regulator with pressure gauge - connections 1/2" NPT (m/f) applied on a pump for regulating the compressed air inlet pressure

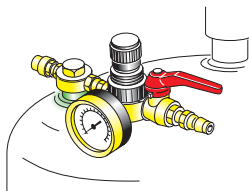

* Articles not manufactured by RAASM

**P/N 37810-55**

Pressure regulator with condensate discharge filter and pressure gauge - connections 1/4" NPT (f/f) for application at the start of the compressed air line feeding the pump

P/N 37819-55

Pressure regulator with condensate discharge filter and pressure gauge - connections 3/8" NPT (f/f) for application at the start of the compressed air line feeding the pump

P/N 37815-55

Pressure regulator with condensate discharge filter and pressure gauge - connections 1/2" NPT (f/f) for application at the start of the compressed air line feeding the pump

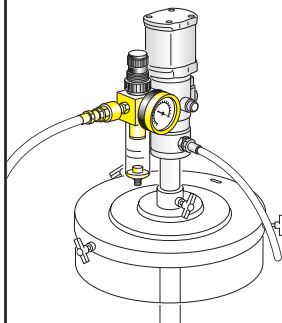

* Articles not manufactured by RAASM

**P/N 37811-55**

Air lubricator - connections 1/4" NPT (f/f) its application guarantees better efficiency of the pump over time

P/N 37820-55

Air lubricator - connections 3/8" NPT (f/f) its application guarantees better efficiency of the pump over time

P/N 37816-55

Air lubricator - connections 1/2" NPT (f/f) its application guarantees better efficiency of the pump over time

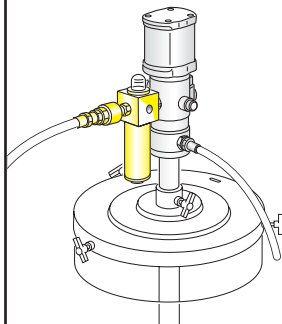

* Articles not manufactured by RAASM

**P/N 37812-55**

Pressure regulator with condensate discharge filter, air lubricator and pressure gauge - connections 1/4" NPT (f/f) the system guarantees that the pump feed air is free of condensate and is lubricated

P/N 37821-55

Pressure regulator same as P/N 37812-55 but with connections 3/8" NPT (f/f)

P/N 37817-55

Pressure regulator same as P/N 37812-55 but with connections 1/2" NPT (f/f)

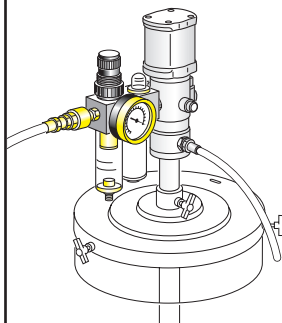

* Articles not manufactured by RAASM



P/N 66855-55

Grease control handle
- inlet 1/4" NPT (f)

P/N 66870-55

Grease control handle
- inlet 3/8" NPT (f)



P/N 66882-55

Grease control handle with rigid terminal - inlet 1/4" NPT (f)
- P/N 66663 triple swivel joint - with special 4-jaw grease coupler

P/N 66873-55

Grease control handle with rigid terminal - inlet 3/8" NPT (f)
- P/N 66667 triple swivel joint - with special 4-jaw grease coupler

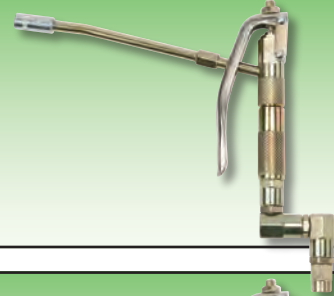

P/N 66889-55

Grease control handle with flexible terminal - inlet 1/4" NPT (f)
- P/N 66663 triple swivel joint - with special 4-jaw grease coupler

P/N 66876-55

Grease control handle with flexible terminal - inlet 3/8" NPT (f)
- P/N 66667 triple swivel joint - with special 4-jaw grease coupler



P/N 66856-55

Flexible extension with special 4-jaw grease coupler - P/N 66740-55
for grease control handle applications

P/N 66857-55

Rigid terminal with special 4-jaw grease coupler - P/N 66740-55
for grease handle application



P/N 66857-55

P/N 66856-55

Flexible hoses

Connecting hoses for systems and equipment, on request
according to needs (see page 123)



P/N 88630-55

Modular drip-tray. Equipped with hook for control handle and
removable drip-tray. Applied under the hose reel, it is a handy holder
for the delivery handle. Essential for a clean and orderly workplace



**P/N 10/81-55**

Single column pump elevator. Elevator is air operated and lifts pump assy via the side mounted 3-ways valve.

P/N 10/85-55

Air operated twin ram hoist for use with suitable industrial pumps are essential when pumping high viscosity and heavy materials. The pump and hoist are raised and lowered by compressed air via the side mounted 3-way valve for quick and easy drum changeovers. When used with a suitable follower plate (supplied separately), it ensures pump prime on the heaviest materials.

**P/N 10/81-55**

Single column industrial pump elevator. Suitable for drums 400 lb (see page 78-79)

No.1 packing 24 ft³ 145 lb

**P/N 10/85-55**

Twin column industrial pump elevator and fluid press. Suitable for drums 400 lb

No.1 packing 65 ft³ 357 lb

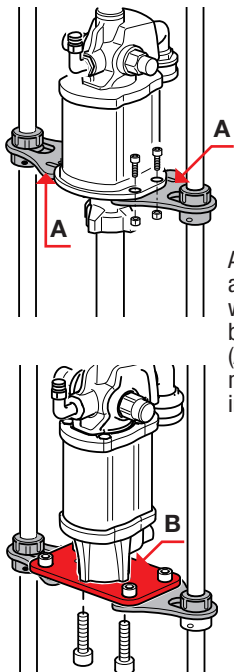
STANDARD BRACKETS

All the elevators are equipped with 2 standard brackets (A - B) suitable for mounting all our industrial pumps

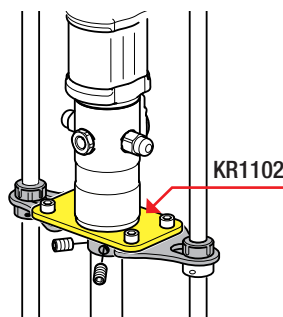
BRACKETS ON REQUEST

KR1102: Special support suitable to mount pump with $\varnothing 1.18$ " suction tube

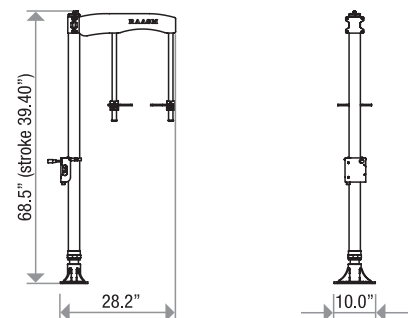
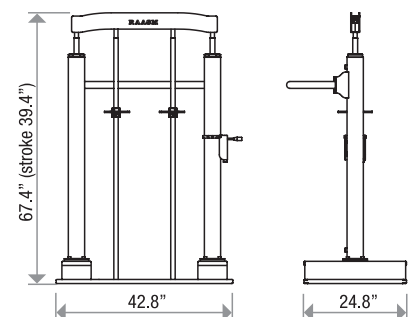
OVERALL DIMENSIONS inches**P/N 10/81-55****P/N 10/85-55**

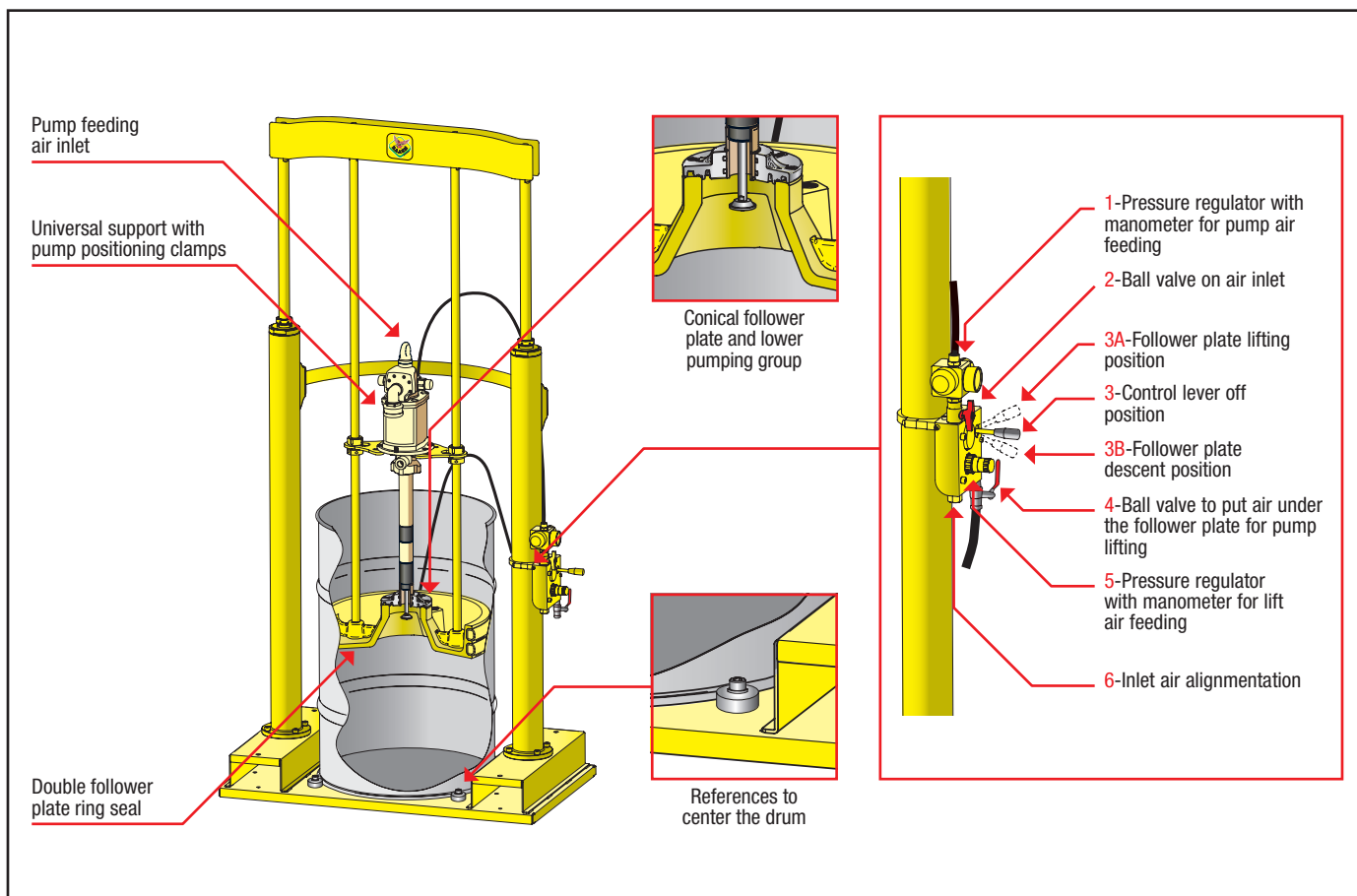

FOLLOWER PLATE FOR RAM HOIST P/N 10/85-55

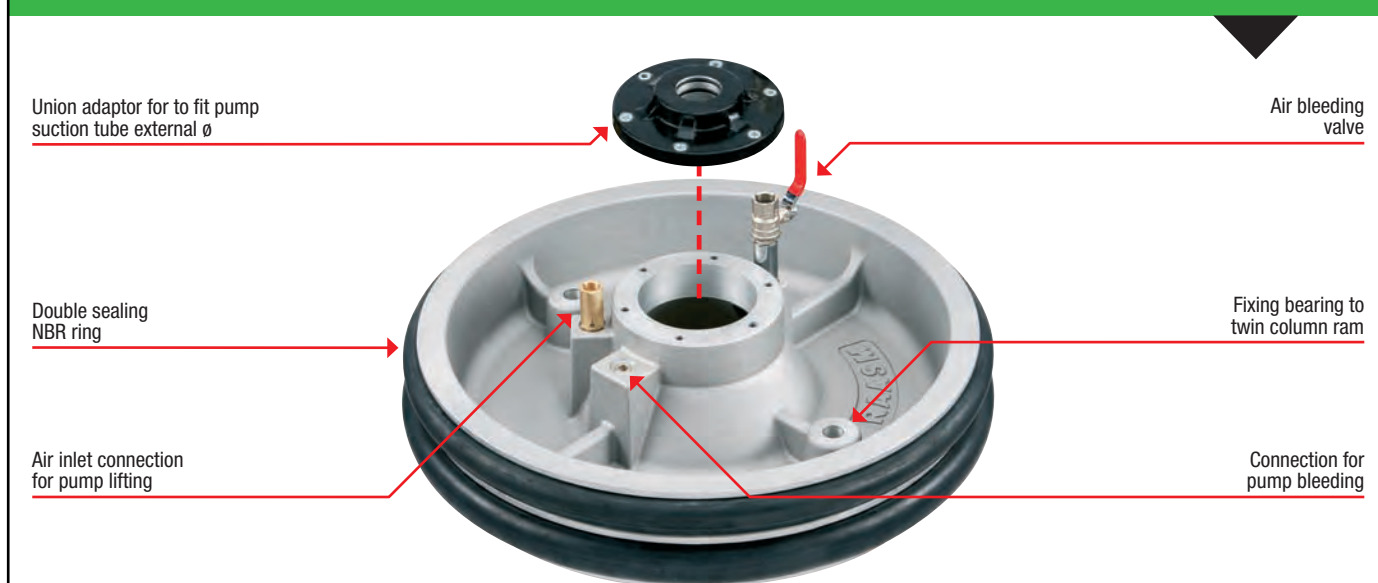

P/N 11/61-55

Follower plate \varnothing 23" for 400 lb drums with NBR double ring seal and adaptor F 1"

P/N 11/62-55

Follower plate \varnothing 23" for 400 lb drums with NBR double ring seal and adaptor F 2"

P/N 11/63-55

Follower plate \varnothing 23" for 400 lb drums with NBR double ring seal and adaptor \varnothing 1.18"

P/N 11/64-55

Follower plate \varnothing 23" for 400 lb drums with NBR double ring seal and adaptor \varnothing 1.77"

P/N 11/65-55

Follower plate \varnothing 23" for 400 lb drums with NBR double ring seal and adaptor \varnothing 2"



Air operated twin column ram hoist for use with industrial pump.

Essential when pumping high viscosity and heavy fluids.

It is raised and lowered by compressed air, via the side mounted 3-way valve. Follower plate ensures pump prime on high viscosity fluids since ram pushes down the follower plate helping pump to work. It is suitable for drums 400 lb.



P/N

10/12401P1N-55

10/09451P1N-55

10/12751P1N-55

10/12181P1N-55

10/09111P1N-55

Twin column ram hoist with industrial pump

P/N 118FSP/401-55
and follower plate
P/N 11/65-55
for 400 lb drums

Twin column ram hoist with industrial pump

P/N 90FSP/451-55
and follower plate
P/N 11/64-55
for 400 lb drums

Twin column ram hoist with industrial pump

P/N 115FSP/751-55
and follower plate
P/N 11/64-55
for 400 lb drums

Twin column ram hoist with industrial pump

P/N 115F/181-55 and
follower plate
P/N 11/64-55
for 400 lb drums

Twin column ram hoist with industrial pump

P/N 90F/111-55 and
follower plate
P/N 11/64-55
for 400 lb drums

 No. 1 packing
65 ft³
510 lb

 No. 1 packing
65 ft³
500 lb

 No. 1 packing
65 ft³
507 lb

 No. 1 packing
65 ft³
491 lb

 No. 1 packing
65 ft³
493 lb

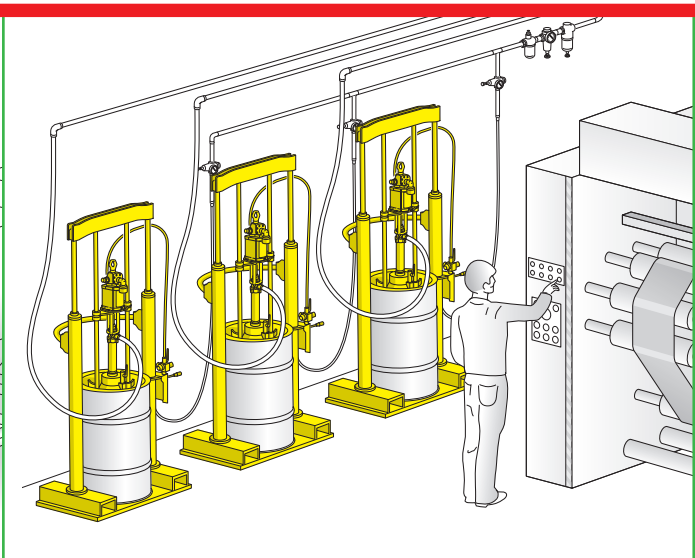
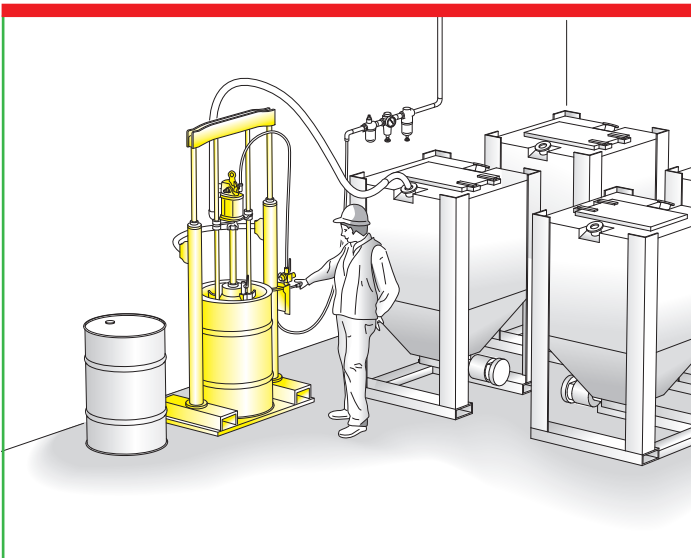

twin column ram: personalized kit 91

In order to satisfy any particular need it is possible to create one's personalized kit choosing pump, follower plate, adaptors and support. We suggest you to look at the information explained in the following pattern.

1	TWIN COLUMN RAM						Twin column ram and pump elevator suitable for 400 lb drums
		P/N	10/85-55				

2	FOLLOWER PLATE	 ø pump suction tube					Follower plates with NBR double o-rings. Equipped with connectors suitable for various sizes of down tube
		P/N	11/65-55	11/64-55	11/63-55	11/62-55	
Suitable for		ø 2" suction tube	ø 1.77" suction tube	ø 1.18" suction tube	F 2" suction tube	F 1" suction tube	

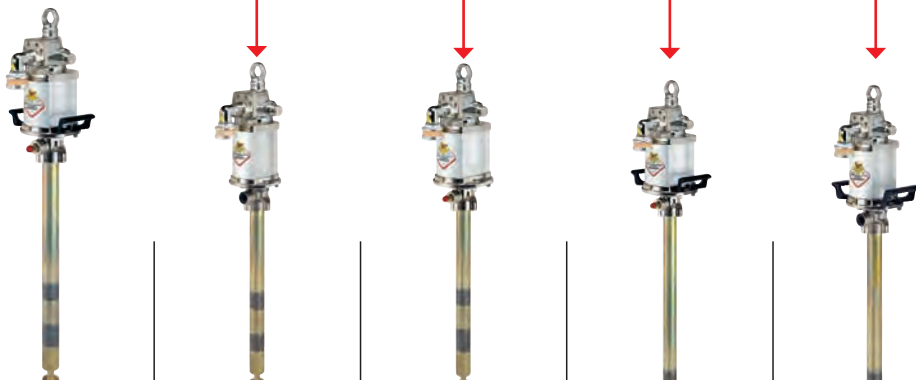
3	PUMPS						Other pumps, here not listed, may be installed on the ram choosing the right follower plate (see page 38-39-79)
		P/N	118FSP/401-55	90FSP/451-55	115FSP/751-55	115F/181-55	
Series		412	312	412	412	312	
Ratio		40:1	45:1	75:1	18:1	11:1	
Flow rate		22 lb/min	9.7 lb/min	9.7 lb/min	37 lb/min	50 lb/min	
Seals		polyurethane	polyurethane	polyurethane	polyurethane	polyurethane	
Suct. tube		23.64"	19.70"	19.70"	18.91"	-	

P/N	10/12401P1N-55	10/09451P1N-55	10/12751P1N-55	10/12181P1N-55	10/09111P1N-55
-----	----------------	----------------	----------------	----------------	----------------



Portable and wheel-mounted lever and pedal-operated pumps.

Practical and functional, they can be used in all workplaces and enable quick, high-pressure greasing on any motor vehicle or mechanism. They are equipped with a grease follower plate that protects the lubricant and ensures positive priming.



manual



air-operated



Do not use flammable or corrosive liquids

P/N 68012-55

P/N 68213-55

Portable high-pressure 5000 - 5800 psi hand-operated grease pump, equipped with:

- 29 lb tank
- grease follower plate
- hose 1/4" - 8'
- rigid extension with 4-jaw grease head

Air-operated grease pump R 50:1, wheel-mounted, equipped with:

- 29 lb tank
- grease follower plate
- P/N 993.504-55 hose 1/4" - 13'
- P/N 62141-55 air pump R 50:1
- P/N 66882-55 grease handle with flexible extension

No.1 packing 2.5 ft³ 23 lb

No.1 packing 3.5 ft³ 37 lb

DETAILS AND ADVANTAGES

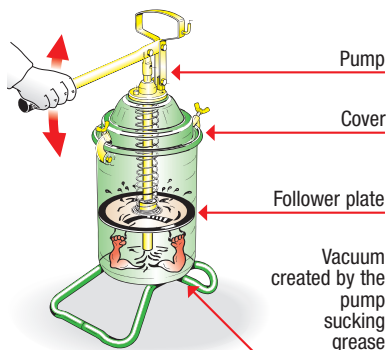

The follower plate, indispensable when using particularly hard greases, is drawn towards the bottom of the drum by the vacuum created by the pump in the grease suction stage

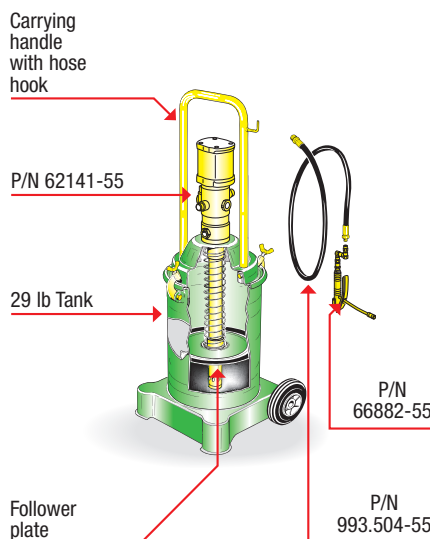

OVERALL DIMENSIONS inches

P/N 68012-55

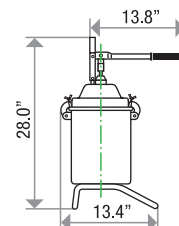

P/N 68213-55

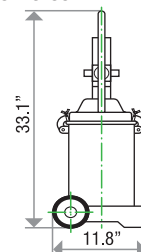

Portable lever-operated manual grease pumps.

Practical and functional, they can be used in all workplaces, and in particular on rough ground such as in farming or building sites. They enable easy change of the grease container (drum or bucket) and quick greasing on any motor vehicle or mechanism. They are equipped with a grease follower plate that protects the lubricant and ensures positive priming.





for drums 26 - 40 lb

P/N 60280-55

Portable high-pressure 5000 - 5800 psi, hand-operated grease pump for drums of 26 - 40 lb with external \varnothing from 9.5" to 10", equipped with:

- manual pump
- drum cover \varnothing 11"
- grease follower plate \varnothing 10"
- hose 1/4" - 8'
- rigid extension with 4-jaw grease head

 No.1 packing 0.8 ft³  lb 12





for drums 35 - 65 lb

P/N 60310-55

Portable high-pressure 5000 - 5800 psi, hand-operated grease pump for drums of 35 - 65 lb with external \varnothing from 10" to 11.5", equipped with:

- manual pump
- drum cover \varnothing 12"
- grease follower plate \varnothing 12"
- hose 1/4" - 8'
- rigid extension with 4-jaw grease head

 No.1 packing 0.8 ft³  lb 14

DETAILS AND ADVANTAGES

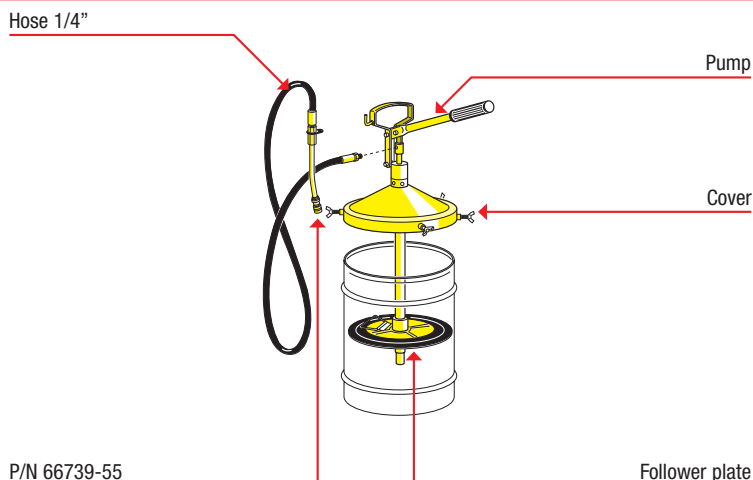

OVERALL DIMENSIONS inches

